

# HEAVY DUTY AIR HYDRAULIC RIVETER

## SPECIFICATIONS

Nose Pieces : 3/32" ( 2.4m/m ) 1/8" ( 3.2m/m ) 5/32" ( 4.0m/m ) 3/16" ( 4.8m/m )

Capacity : For Steel Rivets 3/32" ( 2.4m/m ) -- 3/16" ( 4.8m/m )

Air Pressure : 90 - 100 P.S.I. ( 6kg/cm<sup>2</sup> - 7.0kg/cm<sup>2</sup> )

Stroke Length : 16m/m ( 5/8" )

Traction Power : 850kg ( 1870LBS )

Air Consumption : 4 (Cfm)

Air Inlet : 1/4"

Hose Size : 3/8" I.D.

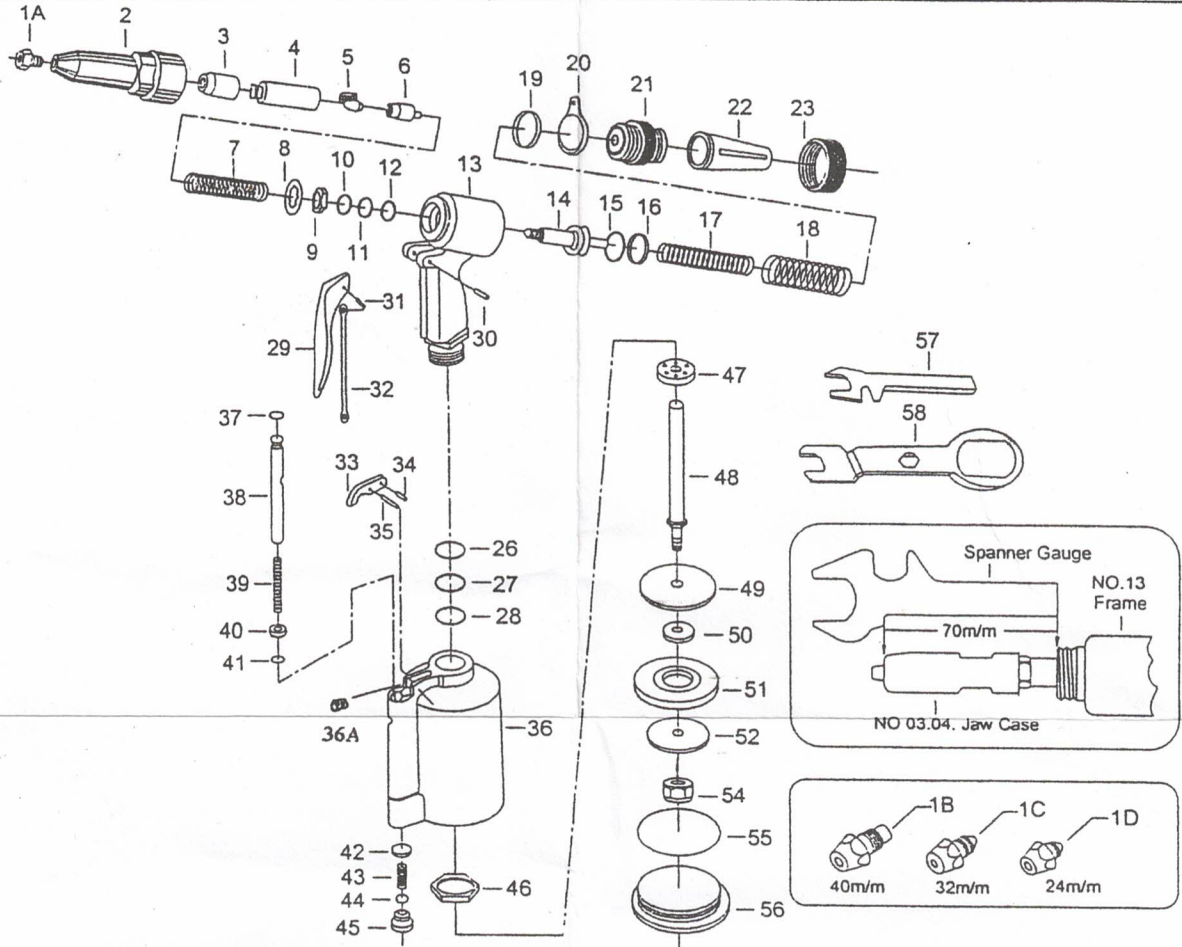

Part No.	Description	Qty	Price
1A	Nose Piece 4.8m/m	1	
1B	Nose Piece 4.0m/m	1	
1C	Nose Piece 3.2m/m	1	
1D	Nose Piece 2.4m/m	1	
02	Frame Head	1	
03	Jaw Case	1	
04	Jaw Case Joint	1	
05	Jaw (5x10)	2	
06	Jaw Pusher	1	
07	Jaw Pusher Spring	1	
08	Jaw Case Washer Ring	1	
09	Jaw Case Lock Nut	1	
10	Frame O-Ring	1	
11	Frame O-Ring	1	
12	Frame Back Up Ring	1	
13	Frame	1	
14	Oil Piston	1	
15	Oil Piston O-Ring	1	
16	Oil Piston Back Up Ring	1	
17	Return Spring A	1	

Part No.	Description	Qty	Price
18	Return Spring B	1	
19	Hanging Clip O-Ring	1	
20	Hanging Clip	1	
21	Frame Cap	1	
22	Safety Cap	1	
23	Frame Cap Nut	1	
26	Frame Joint Back Up Ring	1	
27	Frame Joint O-Ring	1	
28	Frame Joint O-Ring	1	
29	Trigger	1	
30	Trigger Pin	1	
31	Rod Pin	1	
32	Trigger Rod	1	
33	Trigger Lever	1	
34	Rod Pin	1	
35	Lever Pin	1	
36	Air Cylinder	1	
36A	Set Screw	1	
37	Valve Pusher O-Ring	1	
38	Brass Valve Pusher	1	

Part No.	Description	Qty	Price
39	Valve Pusher Spring	1	
40	Valve Pusher Brass Collar	1	
41	Valve Pusher O-Ring	1	
42	Valve	1	
43	Valve Spring	1	
44	Valve Cap O-Ring	1	
45	Valve Cap	1	
46	Frame Lock Nut	1	
47	Rubber Cushion	1	
48	Air Piston Stem	1	
49	Iron Plate Washer	1	
50	Air Piston Iron Plate	1	
51	Air Piston Ring	1	
52	Iron Plate Washer	1	
54	Air Piston Lock Nut	1	
55	Air Cylinder O-Ring	1	
56	Air Cylinder Cap	1	
57	Spanner Gauge	1	
58	Spanner	1	